

### Window locking drive gear

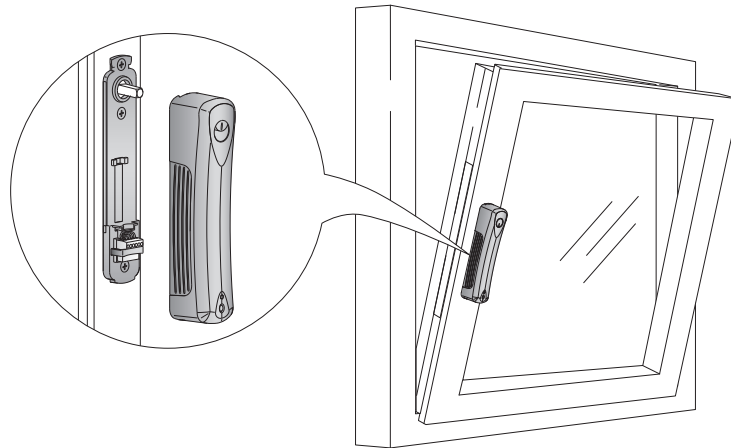

### Application

The MH10 motorised handle for secure, convenient opening and closing of windows impresses with its sturdy structure, high torque, quiet, short operating times and slimline design. The drive is installed in place of the window handle and automatically locks the window upon closing by means of the gear included in the hardware. It offers maximum ease of use, whilst meeting more stringent security requirements.

- For universal use in a variety of window designs and opening types: turn-only, tilt & turn, tilt-only or parallel action windows
- For installation on standard hardware with a controlled top stay (e.g. FAVORIT, TITAN iP)

### Function

- Automatic tilting, locking and unlocking of windows (with handle-driven top stay)
- Automatic locking/unlocking of French doors

### Features

- Simple installation on virtually all profiles and materials without milling
- All opening positions (0°, 90°, 180° and 270°) can be achieved for turning, tilting and parallel action
- Automatic teach in for DIN left and DIN right window opening types
- Attractive design with no protruding locking or operating parts
- Manual emergency operation (e.g. in the event of a power failure) without the need for tools
- 10-minute automatic ventilation function and group control
- Minimal current consumption
- Infrared remote control with wall bracket (optional)
- Separable cable transfer and 24 V power pack connector and/or VPS 1 power supply (depending on equipment)
- 6-wire cable for connecting to a BUS for external control and easy integration into building control technology. The optional weather sensors close and lock the window in the event of wind, cold or rain
- Cables are inserted via the window sash (e.g. glazing rebate or profile chamber)
- Paint finish in all RAL colours available subject to additional charge

**Attention!**

- In the context of project management, the work of the various trades must be carefully coordinated. If SIEGENIA components are being connected to third-party installations or SIEGENIA are being combined with parts by other manufacturers (e.g. drives and controls), technical compatibility must be verified in advance by authorised personnel (e.g. an electrician). For data collation purposes, the technical data sheets and the latest versions of the operating instructions must be handed over to the trades involved when work commences.
- A handle-driven top stay and a turning lock/snapper for crossing the turning position are required for the "tilt" opening function. The hardware must run smoothly and have a maximum torque of 8 Nm.
- The permissible sash geometries and weights can be found in the assembly instructions for the corresponding SIEGENIA profiles.
- The information contained in ASR A 1.6 and VFF data sheet KB.01 for power-operated windows, doors and gates must be observed.

**Technical data**

Supply	Power consumption	Torque	Angle of tilt	Temperature range	Protection class	Dimensions (WxHxD)	Connection
24 V DC, ±15%	1 A	10 Nm	0°, 90°, 180°, 270°	-5 °C to +74 °C	IP 40	42 x 200 x 43 mm	5 m PVC cable

**Unit designs**

Material description	Colour		Remote control	Separable cable transfer	Power pack	Material number
Motorised handle MH10	white	RAL 9016	-	-	-	GAMH0010-004010
	silver	RAL 9006	-	-	-	GAMH0010-0F6010
	white	RAL 9016	Yes	-	-	GMMH0010-004010
	silver	RAL 9006	Yes	-	-	GMMH0010-0F6010
Motorised handle MH10, 90 degree version	white	RAL 9016	-	-	-	GAMH0020-004010
	silver	RAL 9006	-	-	-	GAMH0020-0F6010
Motorised handle MH10, convenience set	white	RAL 9016	Yes	Yes	24 V, 1 A	GMMH0020-004010
	silver	RAL 9006	Yes	Yes	24 V, 1 A	GMMH0020-0F6010

**Accessories**

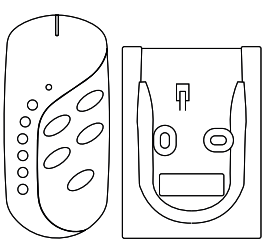
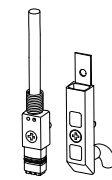
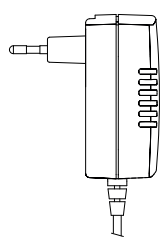
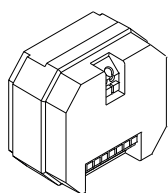
Material description	Remote control, inc. wall bracket and 2 x AAA batteries	Separable cable transfer inc. plug connector and cable (for motor functions only)	Power pack, 24 V DC, 1 A, inc. cable and connecting clamp	VPS 1 power supply unit, 24 V DC, 1 A, for installation in a flush-mounted box
Illustration				
Material number	GZFB0010-025010	GZKT0010-021010	GANS0010-023010	GANE0060-021010